

RL50210 TA

50lb-500lb Capacity Mini Tank Weighing Module



Available in configurations with three or four mounting assemblies.
Picture is a representation of actual product.

The RL50210 TA weigh module kit provides a cost-effective alternative for your customers' low-range weighing needs. A variety of features makes this kit easy to install and an exceptional choice for various indoor weighing applications where checking requirements are low. Environmentally protected load cells, neoprene isolation/compression mounts and other Rice Lake Weighing Systems components are the keys to this module's outstanding performance.

Module with RL50210 or RL50210SS cantilever beam load cell; capacities (per module): 50 lb (22.7 kg), 100 lb (45.4 kg), 150 lb (68.0 kg) and 250 lb (113.4 kg). 500 lb model features RL30000 single-ended beam load cell.



RL50210 TA mild steel (50 lb-250 lb)

Standard Features

- Zinc plated, mild steel modules
- Lower weighing ranges from 50 lb-500 lb (22.7 kg-226.8 kg) per module
- Environmentally protected load cells
- Neoprene isolation/compression mounts allow for minor misalignment, thermal expansion and shock absorption
- Overload stop for 500 lb (226.8 kg) modules provides durability

Applications

- Small tanks and hoppers
- Conveyor/In-motion weighing
- Small platform scales where minor shock loading may be a problem

Optional Features

- Stainless steel modules available in 500 lb (226.8 kg) capacities with RL39123 stainless steel load cells or VPG Sensortronics® 65023 SS load cells
- 65059 kits available with VPG Sensortronics 60040 load cells, capacities: 50 lb-250 lb (22.7 kg-113.4 kg) or 65023 load cells, capacity: 500 lb (226.8 kg)

Complete Kit Includes

- One JB4SS NEMA Type 4X stainless steel signal trim junction box
- Three or four RL50210 cantilever beam load cells (50 lb-250 lb models)
- Three or four RL30000 single-ended beam load cells (500 lb models)
- Three or four RL39123 stainless steel single-ended beam load cells (500 lb)
- Three or four neoprene isolation/compression mounts
- 25 ft of our hostile environment EL147HE SURVIVOR® load cell cable

Load Cell Certifications



Dimensions

Rated Capacity	C	C1	H	H1	L	L1	L2	W	W1	W2	W3
lb/in											
50-250	0.34	—	3.13	0.50	4.00	3.25	2.38	3.88	3.00	2.25	—
500	0.44	0.56	3.88	0.50	6.00	4.00	3.38	5.50	4.00	3.00	4.13
kg/mm											
22.7-113.4	8.6	—	79.5	12.7	101.6	82.6	60.5	98.6	76.2	57.2	—
226.8	11.2	14.2	98.6	12.7	152.4	101.6	85.9	139.7	101.6	76.2	104.9

Order Information

Load Rating (Per Module)*	Part#	Price
Mild Steel Single Module (Includes Load Cell)		
50 lb	17844	Consult
100 lb	17845	Consult
150 lb	17846	Consult
250 lb	17847	Consult
500 lb	17848	Consult
Mild Steel 3-Module Kit		
50 lb	18051	Consult
100 lb	18052	Consult
150 lb	18053	Consult
250 lb	18054	Consult
500 lb	18055	Consult
Mild Steel 4-Module Kit		
50 lb	18057	Consult
100 lb	18058	Consult
150 lb	18059	Consult
250 lb	18060	Consult
500 lb	18061	Consult
Stainless Steel Single Module (Includes Load Cell)		
500 lb	17954	Consult
Stainless Steel 3-Module Kit		
500 lb	30394	Consult
Stainless Steel 4-Module Kit		
500 lb	30393	Consult

VPG Sentionics 65059 Order Information

Load Rating (Per Module)*	Part#	Price
Mild Steel Single Module (Includes Load Cell)		
50 lb	17825	Consult
100 lb	17826	Consult
150 lb	17827	Consult
250 lb	17828	Consult
500 lb	17829	Consult
Mild Steel 3-Module Kit		
50 lb	18063	Consult
100 lb	18064	Consult
150 lb	18065	Consult
250 lb	18066	Consult
500 lb	18067	Consult
Mild Steel 4-Module Kit		
50 lb	18069	Consult
100 lb	18070	Consult
150 lb	18071	Consult
250 lb	18072	Consult
500 lb	18073	Consult
Stainless Steel Single Module (Includes Load Cell)		
500 lb	17950	Consult
Stainless Steel 3-Module Kit		
500 lb	30392	Consult
Stainless Steel 4-Module Kit		
500 lb	30391	Consult

* Load rating is per module

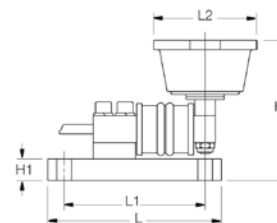
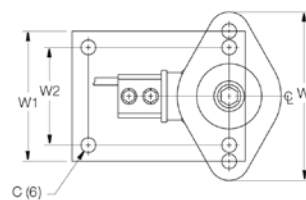

50-250 lb (22.7-113.4 kg)

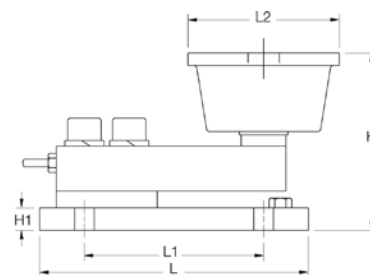
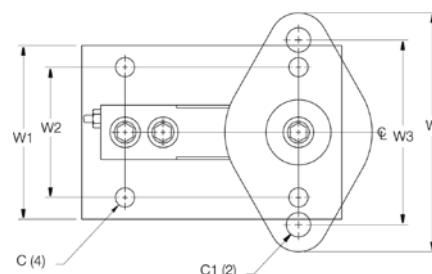

500 lb (226.8 kg)