

# RoughDeck® SD

Sanitary Deck Floor Scale



*Important NOTE: Applications where oily substances may be spilled could cause the deck to become slippery—caution should be used.*

## Specifications

**End Load Capacity:**

100% full scale at 2,000lb and 5,000lb  
80% full scale at 10,000lb

**Cable Length:**

20ft (6.1 m) (for connecting junction box to indicator)

**Remote Junction Box:**

Stainless steel enclosure can be located up to 10ft away from scale

**Warranty:**

RoughDeck SD weldment and load cells two years, all other components one year

**Approvals:**

NTEP CC 92-001, Class III 5,000d

## Standard Features

- Rugged washdown design
- 304 stainless steel construction
- Rigid stainless steel tube frame
- Four stainless steel, welded seal, shear-beam load cells
- Load cells protected on all four sides
- 20 ft (6 m) of SURVIVOR® EL147HE hostile environment load cell cable
- Remote TuffSeal® JB4SS stainless steel NEMA Type 4X junction box
- Four adjustable stainless steel SUREFOOT™ support feet
- Removable polyethylene deck (deck weight: 80lb (36.6kg) on 4ft x 4ft size)
- Side brackets to hold deck during washdown

## APPROVALS



## Underdeck View

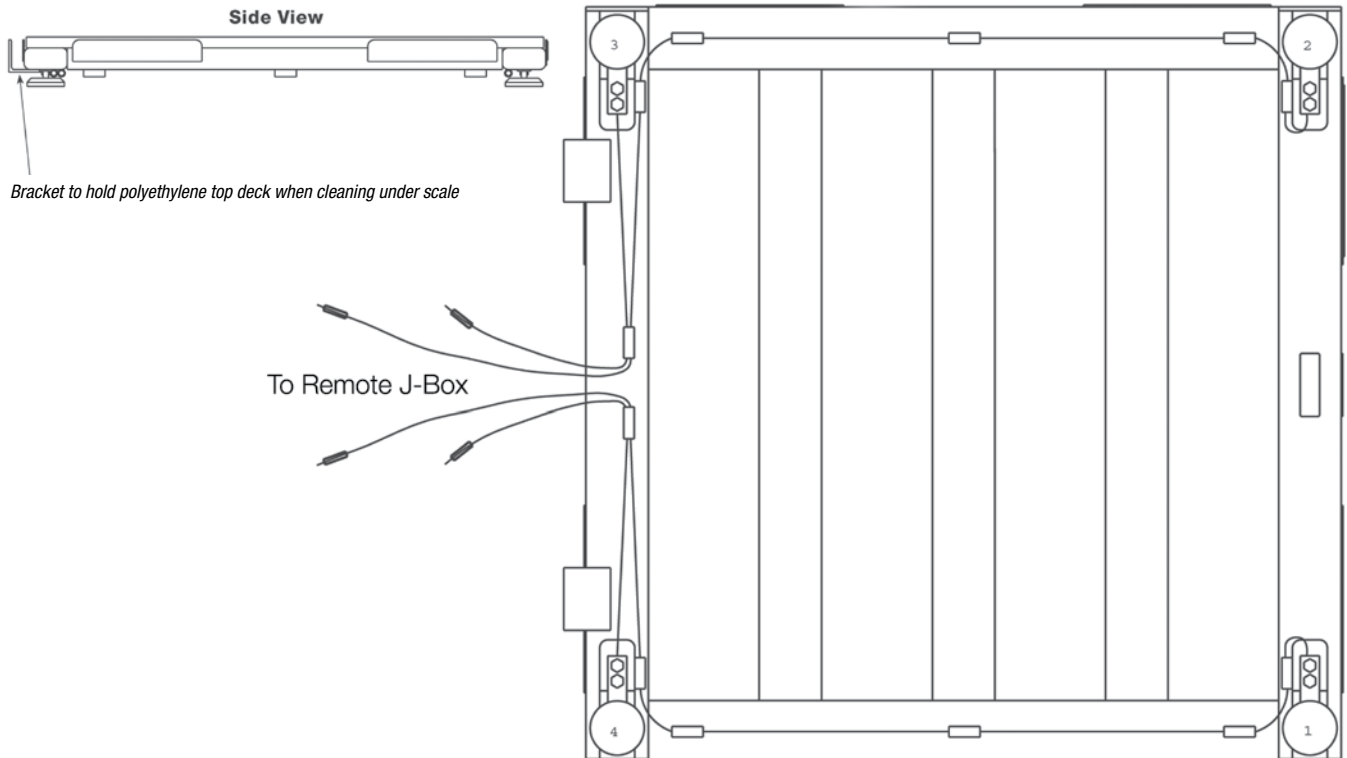

## Part Number/Price

Part #	Size (W x L x H)	Capacity	Est. Weight	Price
50385	2.5 ft x 2.5 ft x 4.4 in	2,000 lb	158 lb	Consult
50386	3 ft x 3 ft x 4.4 in	2,000 lb	208 lb	Consult
50387	4 ft x 4 ft x 4.4 in	2,000 lb	338 lb	Consult
50388	4 ft x 4 ft x 4.4 in	5,000 lb	338 lb	Consult
50389	4 ft x 4 ft x 5.4 in	10,000 lb	447 lb	Consult
50390	4 ft x 5 ft x 4.4 in	2,000 lb	406 lb	Consult
50391	4 ft x 5 ft x 5.4 in	5,000 lb	406 lb	Consult
50392	4 ft x 5 ft x 5.4 in	10,000 lb	540 lb	Consult
50393	4 ft x 6 ft x 5.4 in	2,000 lb	477 lb	Consult
50394	4 ft x 6 ft x 5.4 in	5,000 lb	477 lb	Consult
50395	4 ft x 6 ft x 6.4 in	10,000 lb	637 lb	Consult
50396*	5 ft x 5 ft x 5.4 in	2,000 lb	478 lb	Consult
50397*	5 ft x 5 ft x 5.4 in	5,000 lb	478 lb	Consult
50398*	5 ft x 5 ft x 5.4 in	10,000 lb	637 lb	Consult
50399*	5 ft x 7 ft x 6.4 in	2,000 lb	705 lb	Consult
50400*	5 ft x 7 ft x 6.4 in	5,000 lb	705 lb	Consult
50401*	5 ft x 7 ft x 6.4 in	10,000 lb	908 lb	Consult

\* Constructed of two pieces of polyethylene to make up the top deck.

## Options/Accessories

Part #	Description	Price
28740	RoughDeck floor stand for indicator, 36.3 in high, stainless steel	Consult
N/A	Stainless steel deck with RL35082 hermetically sealed IP69K stainless steel (cFMus approved) load cells and hardware	+Consult list price add-on
18778	Floor anchor plates, stainless steel (set of 2)	Consult

Consult factory for these additional options:

- Access ramps
- Pit frames