

RL20000

Alloy Steel, Environmentally Sealed, NTEP Certified 1:5,000 III/1:10,000 IIIL, IP67

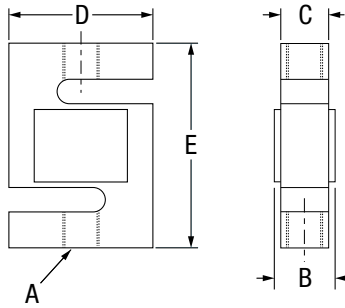

Picture is a representation of actual product

Dimensions

Rated Capacity	A	B	C	D	E
lb/in					
25-300	1/4-28 UNF	0.75	0.50	2.00	2.50
500-1,500	1/2-20 UNF	1.00	0.75	2.00	2.50
2,000-2,500	1/2-20 UNF	1.25	1.00	2.00	2.50
3,000	1/2-20 UNF	1.25	1.00	3.00	4.00
5,000-10,000	3/4-16 UNF	1.25	1.00	3.00	4.00
15,000	1-12 UNF	1.50	1.25	4.00	5.50
20,000	1 1/4-12 UNF	2.25	2.00	5.00	7.00
kg/mm					
11.3-136.1	1/4-28 UNF	19.1	12.7	50.8	63.5
226.8-680.4	1/2-20 UNF	25.4	19.1	50.8	63.5
907.2-1,134.0	1/2-20 UNF	31.8	25.4	50.8	63.5
1,360.8	1/2-20 UNF	31.8	25.4	76.2	101.6
2,268.0-4,535.9	3/4-16 UNF	31.8	25.4	76.2	101.6
6,803.9	1-12 UNF	38.1	31.8	101.6	139.7
9,071.9	1 1/4-12 UNF	57.2	50.8	127.0	177.8

Order Information

Load Rating		Part #	Est. Weight	Price
25 lb	11.3 kg	21428	2 lb	Consult
50 lb	22.7 kg	21429	2 lb	Consult
75 lb	34.0 kg	21430	2 lb	Consult
100 lb	45.4 kg	21431	2 lb	Consult
150 lb	68.0 kg	21432	2 lb	Consult
200 lb	90.7 kg	21433	2 lb	Consult
250 lb	113.4 kg	21434	2 lb	Consult
300 lb	136.1 kg	21435	2 lb	Consult
500 lb	226.8 kg	21436	2 lb	Consult
750 lb	340.2 kg	21437	2 lb	Consult
1,000 lb	453.6 kg	21438	2 lb	Consult
1,500 lb	680.4 kg	21439	2 lb	Consult
2,000 lb***	35 ft cable	21356	2 lb	Consult
2,000 lb	907.2 kg	21440	2 lb	Consult
2,500 lb	1,134.0 kg	21441	2 lb	Consult
3,000 lb	1,360.8 kg	21442	4 lb	Consult
5,000 lb***	30 ft cable	17044	4 lb	Consult
5,000 lb	2,268.0 kg	21443	4 lb	Consult
10,000 lb	4,535.9 kg	21444	4 lb	Consult
15,000 lb	6,803.9 kg	21445	7 lb	Consult
20,000 lb***	30 ft cable	17045	17 lb	Consult
20,000 lb	9,071.9 kg	21446	17 lb	Consult
Conduit Adapter Kit* (must be factory installed to maintain warranty)				
3/8-24 nipple		31533*	1 lb	Consult
3/8-24 to 1/4-18 NPT		31534*	1 lb	Consult
Replacement Agriculture Scale Load Cell - 40 ft Cable				
10,000 lb	4,535.9 kg	151746	5 lb	Consult

*PN 31533 and PN 31534 must be installed together to form the Conduit Adapter Kit

***These load cells have 30 ft or 35 ft of cable and trimmed outputs and are used in many batch plants

Interchangeable Products

ARTECH®
20210 (1-14 UNF) (15,000 lb thread is 1-12 UNF for Rice Lake model)

Weigh Module Available

RICE LAKE WEIGHING SYSTEMS
ITCM
Isolated Tension Cell Mount page 44

Specifications

- Full Scale Output:**
3.0 mV/V
- Output Resistance:**
350 (± 3) ohm
- Input Resistance:**
385 (± 5) ohm
- Material/Finish:**
High-alloy steel, nickel plated
- Temperature:**
Compensated range:
14° F to 104° F/-10° C to 40° C
Operating range:
-40° F to 150° F/-40° C to 65° C
- Seal Type:**
Environmentally sealed, IP67
- Safe Overload:**
150% full scale
- Rated Excitation:**
5-10 VDC (15 V maximum)
- Combined Error:**
0.02%
- Insulation Resistance:**
5,000 megohms
- Cable Length:**
20 ft (6.1 m)
- Cable Diameter:**
0.200 polyurethane jacket
- Cable Color Code:**
Red+ Excitation
Black.....- Excitation
Green+ Signal
White- Signal
- Warranty:**
Two-year limited warranty

Approvals:

