

RL35023

Alloy Steel, Environmentally Sealed, NTEP Certified 1:5,000 Class III Multiple Cell, IP67



Dimensions

Picture is a representation of actual product

Rated Capacity	A1	A2	A3	B	C	D	E	F	G
lb/in									
500	1/2-20UNF	0.50	0.53	1.25	1.00	5.12	1.00	3.00	0.50
1,000-5,000 SE*	1/2-20UNF	0.62	0.53	1.25	1.25	5.12	1.00	3.00	0.50
5,000 LE**-10,000	3/4-16UNF	0.75	0.78	1.50	1.50	6.75	1.50	3.75	0.75
15,000-20,000	1-14UNS	1.00	1.03	2.00	2.00	8.88	2.00	4.88	1.03
kg/mm									
226.8	1/2-20UNF	12.7	13.5	31.8	25.4	130.1	25.4	76.2	12.7
453.6-2,268.0 SE*	1/2-20UNF	15.8	13.5	31.8	31.8	130.1	25.4	76.2	12.7
2,268.0 LE**-4,535.9	3/4-16UNF	19.1	19.8	38.1	38.1	171.5	38.1	95.3	19.8
6,803.9-9,071.9	1-14UNS	25.4	26.2	50.8	50.8	225.6	50.8	124.0	25.0

Order Information

Load Rating		Part #	Est. Weight	Price
NTEP Certified				
1,000 lb	453.6 kg	21528	3 lb	Consult
2,000 lb	907.2 kg	21529	3 lb	Consult
2,500 lb	1,134.0 kg	21530	3 lb	Consult
3,000 lb	1,360.8 kg	21531	3 lb	Consult
4,000 lb	1,814.4 kg	21532	3 lb	Consult
5,000 lb SE*	2,268.0 kg	21535	3 lb	Consult
5,000 lb LE**	2,268.0 kg	21533	5 lb	Consult
10,000 lb	4,535.9 kg	21534	5 lb	Consult
Non-NTEP Certified				
500 lb	226.8 kg	17181	3 lb	Consult
15,000 lb	6,803.9 kg	17186	10 lb	Consult
20,000 lb	9,071.9 kg	17187	10 lb	Consult
20,000 lb***	9,071.9 kg	166127	10 lb	Consult
Conduit Adapter Kit (must be factory installed to maintain warranty)				
3/8-24 nipple		31533	1 lb	Consult
3/8-24 to 1/4-18 NPT		31534	1 lb	Consult

* SE refers to small envelope ** LE refers to large envelope *** Overbraided cable

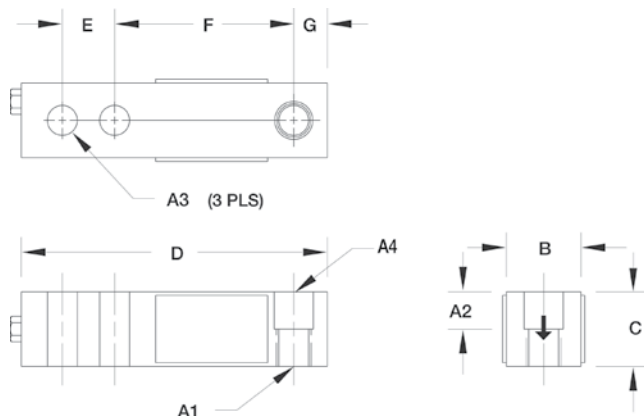

Interchangeable Products

- VPG CELTRON®
SQB..... page 214
- VPG SENSORTRONICS®
65023A..... page 319

Weigh Module Available

- RICE LAKE WEIGHING SYSTEMS
RL50210 TA..... page 52
- RICE LAKE WEIGHING SYSTEMS
RL1800 Series..... page 62

Specifications

- Full Scale Output:**
3.0 mV/V
- Output Resistance:**
349-355 ohm
- Input Resistance:**
343-357 ohm
- Material/Finish:**
High-alloy steel, nickel plated
- Temperature:**
Compensated range
14°F to 104°F/-10°C to 40°C
Operating range
-40°F to 150°F/-40°C to 65°C

- Safe Overload:**
150% full scale
- Safe Sideload:**
100% full scale
- Rated Excitation:**
5-10 VDC (15 V maximum)
- Nonlinearity:**
0.03% full scale
- Hysteresis:**
0.02% full scale
- Insulation Resistance:**
5,000 megohms

- Deflection at Capacity:**
500 lb-1,000 lb=0.013 in (0.3 mm)
2,000 lb-3,000 lb=0.015 in (0.4 mm)
4,000 lb-5,000 lb=0.025 in (0.6 mm)
10,000 lb=0.035 in (0.9 mm)

- Seal Type:**
Environmentally sealed, IP67

- Cable Length:**
20 ft (6.1 m)

- Cable Diameter:**
0.200 polyurethane jacket

- Cable Color Code:**
Red+ Excitation
Black.....- Excitation
Green+ Signal
White- Signal

- Warranty:**
Two-year limited warranty

Approvals:

