

110AH

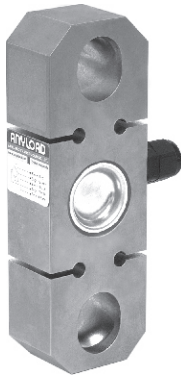

Alloy Steel; Patent Design



Capacity ≤ 20t Cable φ5.1×3m
 Capacity ≥ 30t Cable φ5.1×10m

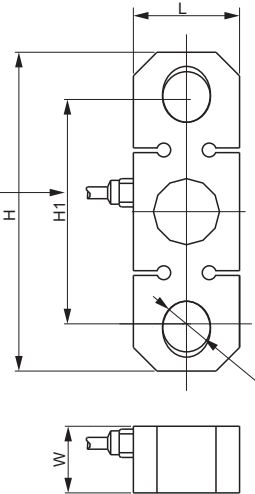

CE RoHS

DIMENSIONS

RATED CAPACITY	C	H	H1	L	W
t/mm					
2	20.0	145.0	95.0	50.0	15.0
5	25.0	145.0	100.0	45.0	28.2
20	44.0	244.0	165.0	85.0	55.0
30	52.0	318.0	220.0	112.0	66.0
50	70.0	436.0	294.0	140.0	88.0
lb/inches (conversion of above dimensions)					
4,409.2	0.79	5.71	3.74	1.97	0.59
11,023.1	0.98	5.71	3.94	1.77	1.11
44,092.5	1.73	9.60	6.50	3.37	2.17
66,138.7	2.05	12.52	8.66	4.41	2.60
110,231.1	2.76	17.17	11.57	5.51	3.46

SPECIFICATIONS

Full Scale Output	2.0 mV/V ± 10%	Recommended Excitation	10V (15V Maximum)
Zero Balance	± 0.05 mV/V	Insulation Resistance	> 2 [50V DC] GΩ
Non-linearity	< ± 0.017%	Compensated Temperature Range	-10°C to 40°C / 14°F to 104°F
Repeatability	< ± 0.017%	Safe Overload	200% of full scale
Hysteresis Error	< ± 0.017%	Breaking Overload	400% of full scale
Creep in 30 min.	< ± 0.023%	Seal Type / IP Rating	Environmentally Sealed / IP67
Input Resistance	400Ω ± 20	Cable Color Code	Exc+ Red Exc- Black
Output Resistance	350Ω ± 3		Sig+ Green Sig- White
Element Material	Alloy Steel, Nickel Plated		Shield Bare

PART NUMBER

Rated Capacity	Part No.	Shipping Weight (kg) Approx.
2t.....	110AH-2t.....	0.8
5t.....	110AH-5t.....	1.2
20t.....	110AH-20t.....	7.4
30t.....	110AH-30t.....	16.0
50t.....	110AH-50t.....	40.0

TENSION LINKS