

HBB

Stainless Steel, Welded Seal, IP67



**DISCONTINUED
LIMITED STOCK
AVAILABLE**

Dimensions

Picture is a representation of actual product

Rated Capacity	L	L1	L2	L3	L4	L5	L6	H	H1	H2	H3	W	W1
kg/mm													
10-250	120.0	18.0	82.0	10.0	19.0	41.0	38.0	41.6	28.2	20.0	10.0	31.5	26.6
lb/in													
22.7-551.2	4.72	0.70	3.22	0.39	0.74	1.61	1.49	1.63	1.11	0.78	0.39	1.24	1.04

Order Information

Load Rating	Part#	Est. Weight	Price
100kg	69323	2lb	Consult

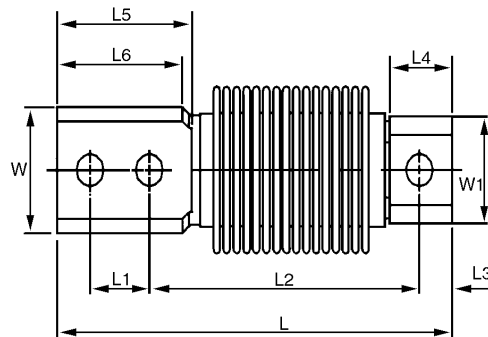
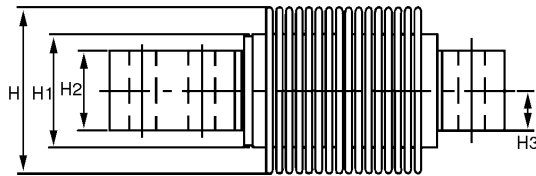

Interchangeable Products

RICE LAKE WEIGHING SYSTEMS

RLHBB page 152

HBM®

Z6 page 262

VPG REVERE®

SHB page 291

VPG TEDEA-HUNTLEIGH®

355 page 349

METTLER TOLEDO®

MTB —

Specifications

Full Scale Output:

2.0 mV/V

Output Resistance:

350 (± 3) ohm

Input Resistance:

385 (± 5) ohm

Material/Finish:

Stainless steel

Temperature:

Operating range
0°F to 150°F (-18°C to 65°C)

Seal Type:

Welded-seal, IP67

Safe Overload:

150% full scale

Rated Excitation:

5-10 VDC (15 V maximum)

Combined Error:

0.03%

Insulation Resistance:

5,000 megohms

Cable Length:

3.1 m (10 ft)

Cable Diameter:

0.200 polyurethane jacket

Cable Color Code:

Red +Excitation
Black -Excitation
Green +Signal
White -Signal
Brown +Sense
Yellow -Sense

Warranty:

One-year limited warranty