

WMC Miniature Sealed

Stainless Steel

**Dimensions**

Picture is a representation of actual product

Rated Capacity lb/in	A	B	C	D	E	F	G	H
5-10	0.45 (11.4 mm)	0.06 (1.5 mm)	0.75 (19.1 mm)	0.25 (6.4 mm)	6-32UNC M4x0.7	0.50 (12.7 mm)	0.39 (9.9 mm)	1.01 (25.7 mm)
25-100	0.52 (13.2 mm)	0.03 (0.8 mm)	1.00 (25.4 mm)	0.25 (6.4 mm)	10-32UNF M5x0.8	0.50 (12.7 mm)	0.39 (9.9 mm)	1.05 (26.7 mm)
250-500	0.53 (13.4 mm)	0.03 (0.8 mm)	1.00 (25.4 mm)	0.38 (9.7 mm)	1/4-28UNF M6x1	0.50 (12.7 mm)	0.39 (9.9 mm)	1.32 (33.5 mm)
1,000	0.53 (13.4 mm)	0.03 (0.8 mm)	1.00 (25.4 mm)	0.38 (9.7 mm)	0.250-28UNF M6x1	0.50 (12.7 mm)	0.39 (9.9 mm)	1.32 (33.5 mm)
2,000-3,000	0.72 (18.3 mm)	0.03 (0.8 mm)	1.00 (25.4 mm)	0.50 (12.7 mm)	0.375-24UNF M10x1.5	0.50 (12.7 mm)	0.39 (9.9 mm)	1.75 (44.5 mm)
5,000	0.94 (23.9 mm)	0.03 (0.8 mm)	1.25 (31.8 mm)	0.63 (16.0 mm)	0.500-20UNF M12x1.75	0.50 (12.7 mm)	0.39 (9.9 mm)	2.23 (56.6 mm)
7,500-10,000	1.09 (27.7 mm)	0.03 (0.8 mm)	1.38 (34.9 mm)	0.88 (22.4 mm)	0.750-16UNF M16x2	0.50 (12.7 mm)	0.39 (9.9 mm)	2.88 (73.2 mm)

Order Information

Load Rating	Part#	Est. Weight	Price
5 lb	185090	1 lb	Consult
10 lb	185091	1 lb	Consult
25 lb	185092	1 lb	Consult
50 lb	185093	1 lb	Consult
100 lb	185094	1 lb	Consult
250 lb	185095	1 lb	Consult
500 lb	185096	1 lb	Consult
1,000 lb	185084	1 lb	Consult
2,000 lb	185085	1 lb	Consult
3,000 lb	185086	1 lb	Consult
5,000 lb	185087	1 lb	Consult
7,500 lb	185088	1 lb	Consult
10,000 lb	185089	1 lb	Consult

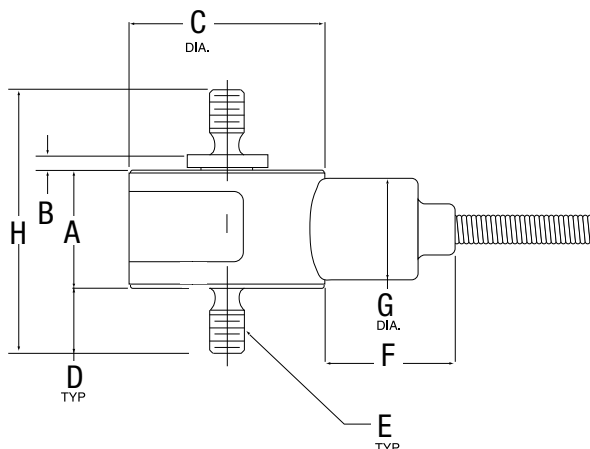
**Specifications****Full Scale Output:**
2.0 mV/V**Bridge Resistance:**
350 ohms, nominal**Material/Finish:**
Stainless steel**Temperature:**
Operating range
-65°F to 250°F**Safe Overload:**
150% full scale**Rated Excitation:**
12 VDC**Nonlinearity:**
± 0.15% full scale (5-500lb)
± 0.20% full scale (1-10K)**Hysteresis:**
± 0.15% full scale (5-500lb)
± 0.20% full scale (1-10K)**Insulation Resistance:**
> 5,000 megohms**Cable Length:**
5 ft (1.5 m)**Cable Color Code:**
Red +Excitation
Black -Excitation
White +Signal
Green -Signal**Warranty:**
One-year limited warranty