

4 conductor ribbon cable  
1.5m length

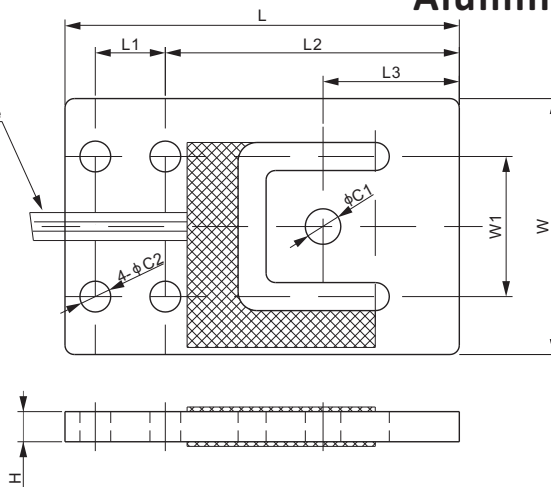

CE RoHS

### DIMENSIONS

RATED CAPACITY	C1	C2	H	L	L1	L2	L3	W	W1
<b>kg/mm</b>									
3.75	5.1	5.1	2.0	70.0	14.0	51.1	23.1	39.0	27.8
7.5	5.1	5.1	3.0	70.0	14.0	51.1	23.1	39.0	27.8
15	7.6	5.1	4.1	70.0	14.0	51.1	23.1	39.0	27.8
37.5	7.6	6.6	4.8	76.2	15.0	55.2	25.9	44.5	30.0
75	7.6	6.6	6.5	84.5	15.0	63.0	29.2	54.8	30.0
150	9.1	8.1	7.9	107.3	22.9	76.6	30.7	69.9	44.5
375	9.1	9.8	12.7	119.4	25.4	84.9	32.3	76.1	50.8
<b>lb/inches</b> (conversion of above dimensions)									
8.27	0.20	0.20	0.08	2.76	0.55	2.01	0.91	1.54	1.10
16.5	0.20	0.20	0.12	2.76	0.55	2.01	0.91	1.54	1.10
33	0.30	0.20	0.16	2.76	0.55	2.01	0.91	1.54	1.10
82.7	0.30	0.26	0.19	3.00	0.59	2.17	1.02	1.75	1.18
165	0.30	0.26	0.26	3.33	0.59	2.48	1.15	2.16	1.18
331	0.36	0.32	0.31	4.22	0.90	3.02	1.21	2.75	1.75
827	0.36	0.39	0.50	4.70	1.00	3.34	1.27	3.00	2.00

PLANARS

### SPECIFICATIONS

<b>Full Scale Output</b>	0.9 mV/V $\pm$ 0.1%	<b>Element Material</b>	Aluminum
<b>Calibration in mV/V/<math>\Omega</math></b>	$\pm$ 0.05%	<b>Recommended Excitation</b>	10V (15V Maximum)
<b>Zero Balance</b>	$\pm$ 0.02 mV/V	<b>Insulation Resistance</b>	>2 [ 50V DC ] G $\Omega$
<b>Non-linearity</b>	< $\pm$ 0.020%	<b>Nominal Temperature Range</b>	-10°C to 40°C / 14°F to 104°F
<b>Repeatability</b>	< $\pm$ 0.017%	<b>Safe Overload</b>	150% of full scale
<b>Hysteresis Error</b>	< $\pm$ 0.015%	<b>Breaking Overload</b>	300% of full scale
<b>Creep in 30 min.</b>	< $\pm$ 0.015%	<b>Seal Type / IP Rating</b>	Environmentally Sealed / IP65
<b>Input Resistance</b>	1190 $\Omega$ $\pm$ 10	<b>Cable Color Code</b>	Exc+ Red      Exc- Black Sig+ Green    Sig- White
<b>Output Resistance</b>	1000 $\Omega$ $\pm$ 10		

### PART NUMBER

Rated Capacity	Part No.	Weight (kg) Approx.
3.75kg.....	202UA-3.75kg.....	0.1
7.5kg.....	202UA-7.5kg.....	0.1
15kg.....	202UA-15kg.....	0.1
37.5kg.....	202UA-37.5kg.....	0.1
75kg.....	202UA-75kg.....	0.1
150kg.....	202UA-150kg.....	0.2
375kg.....	202UA-375kg.....	0.4

### INTERCHANGEABLE PRODUCTS

Manufacturer	Model
FLINTEC.....	PB
Rice Lake.....	RL BLP

### INSTALLATION DRAWING

